

## Vitrom Manufacturing Consultants

Vitrom Manufacturing Consultants has the diverse capabilities and experience required to design customized manufacturing machinery and processes for your needs. Our development approach ensures that our clients are always informed and in control of the project. This approach provides our customers for prompt decision making so as to achieve rapid product development, acceptable initial quality and manufacturing productivity.

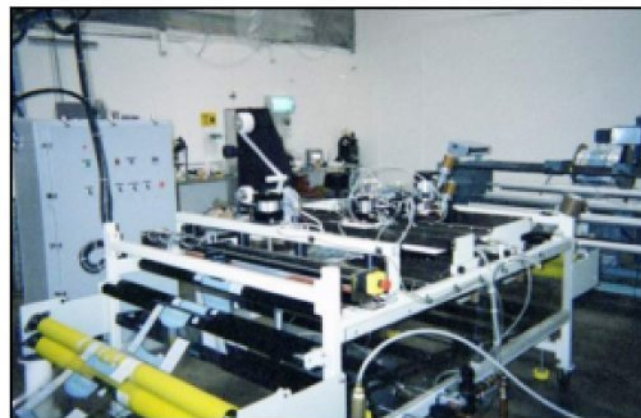
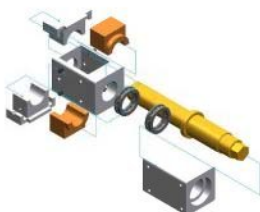
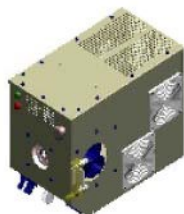

## We develop customized Manufacturing Equipment and Processes

### Mechanical and Controls System Design

- Conceptual Design
- Mechanical Design
- Control Systems Design
- Systems Automation

### Engineering

- Project Management
- Specifications
- Quality Systems

### Development

- Tooling Development
- Product Development and Optimization
- Process Development

### Field Service

- Equipment Installation
- Start-up
- Debug

### Maintenance Solutions

- Preventive Maintenance Programs
- Personnel Training
- Documentation
- Maintenance Procedures

## We are a team of professionals that you can trust

We are a full-service product development firm specializing in the seamless transfer between conceptual and detailed design, engineering, and manufacturing. Services include industrial design, mechanical engineering, system analysis, and prototype development for packaging equipment, materials transfer systems, converting equipment, and diagnostic instruments.

We have designed and build automated equipment to process, assemble, inspect, and package a variety of products. We are experienced integrators of material transfer systems for bulk processing of powders and other products.

We have a proven track record of developing custom machinery, automated industrial processes and industrial products.

**For more information please contact us**

Phone: 209-834-1900 Fax: 209-834-1039  
Email: Reis@vitrom.com

3941 Holly Drive Suite K, Tracy CA 95304

**VISIT US AT WWW.VITROM.COM**

# TOTAL PRODUCTIVE MAINTENANCE SYSTEMS

**A philosophy of monitoring the state of the equipment and taking actions before any possible break down and serious down time occurs.**

## VITROM ADDRESSES:

- PREVENTIVE MAINTENANCE
- PREDICTIVE MAINTENANCE
- PREFABRICATED WORK
- CORRECTIVE WORK
- EQUIPMENT OVERHAUL

BETTER EQUIPMENT PERFORMANCE  
AND  
BETTER EQUIPMENT RELIABILITY



## PROJECT APPROACH

### 1. Definition of the project:

- develop an understanding of client's requirements, expectations, areas of concern and schedules
- determine the objectives and scope of the project
- determine the technology competency requirements to achieve the project's objectives
- assess our technical competencies comprising engineering staff, resources, facilities, tools and processes to finish the project.

### 2. Proposal:

- set the working relationship with the customer
- define the objective, scope, deliverables, schedule, budget, and terms
- define milestones and project phases as well as the criteria to exit those phases
- defines metrology and results to be achieved within a preset time and budget

### 3. Execution:

- execute tasks defined by client agreement and specifications.
- provide timely reports to client addressing the project progress and difficulties
- jointly with the customer, refine the project tasks to most effectively achieve the project objectives
- test the design, present the findings and recommendations
- execution of additional tasks which result from discussions with customer, augments finds, and others

## Results:

New or improved technology sources, new or improved manufacturing process, better market entry strategies, better yields, reduced down time and improved profits.